



The Leader in Integrated
Fire Doors and Smoke
Curtain Technology

Integrated Doors

Fire Protective Smoke Curtains

Door Systems
1150 S Las Brisas
Placentia, CA 92870
(866) 534-DOOR (3667)



Door Systems Newsletter

January 2024

INTEGRATED DOORS AND SMOKE & FIRE CURTAINS by Door Systems



Introducing DSI-HS10B Hose Stream Fire Curtain

A UL 10B rated fire curtain with a 180-minute rating!

The DSI-HS10B Hose Stream Rated Smoke and Fire Curtain incorporates the cutting-edge technology of our UL 10D fabric curtains but with the advantage of being code-compliant in any firewall rated up to 3 hours.

Compliant with:

- UL 10B: With Hose Stream – 180 minutes
- UL 1784: Air leakage test of door assemblies

DOOR SYSTEMS

“The SMOKE & FIRE CONTAINMENT People”

UL 10B Hose Stream Rated Curtains

Deployable Fabric Fire Walls

Floor Opening Protection



The **SMOKE** and **FIRE CONTAINMENT** People
doorsysinc.com

DSI-HS10B Fire Curtain can be used in firewalls and fire barrier walls as a replacement solution to traditional Coiling Steel Fire doors. The DSI-HS10B Fire Curtain uses stainless-steel wirereinforced glass fabric with a specially formulated, fire-retardant coating on both sides. That achieves a high-temperature resistance of up to 2012 °F and maintains integrity thanks to its UL 10B label, with up to 180-minute rating that includes the Hose Stream Test.

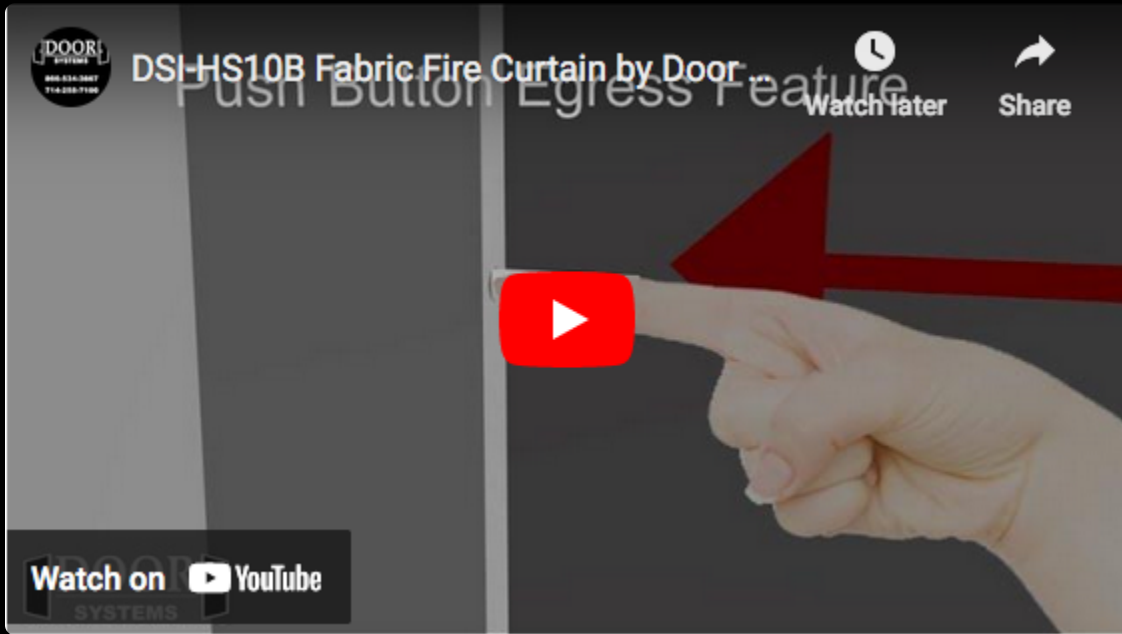

Features & Qualifications	DSI-HS10B HOSE STREAM RATED SMOKE AND FIRE CURTAIN	Overhead Coiling Steel Fire Doors
Fire Label	UL 10B with Hose Stream	UL 10B with Hose Stream
Fire Rating	20, 90, or 180 minutes	20, 90, or 180 minutes
Smoke Label	UL 1784 (Standard)	UL 1784 (Optional)*
Smoke Seals	Not Required	Required for "S" Label
Fail Safe Operation	Standard	Optional for an added cost
Minimum Head Room Requirement	9"	16"
Maximum Head Room Requirement	12"	30"
Side Clearance Required	4" on all sizes	Varies from 7 1/2" - 13 1/2"
Weight	3-5 lbs. per Sq. Ft.	13-15 lbs. per Sq. Ft.
Maximum Opening Size	984' Wide x 26' Tall*	24' Wide x 24' Tall*

Maximum Opening Size	304" WIDE X 20" Tall	24" WIDE X 24" Tall
Activation Function	Fire Alarm &(or) Fusible Link	Fire Alarm &(or) Fusible Link
Auto Reset Function	Standard	Optional for an added cost
Egress	Multiple options available	Not available
Battery Back-up	Standard	Optional for an added cost
Power Requirements	24V standard	120V Minimum
Finishes	Factory Primed finish	Factory Primed finish

DSI-HS10B Vs. Steel Fire Doors

The assembly includes a single compact headbox typically installed above the ceiling with side guides integrated into the wall, making the system virtually invisible until activated.

HEADBOX FINISHING OPTIONS

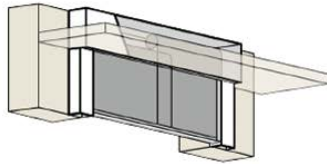

Flush to Ceiling (HBFC_01)

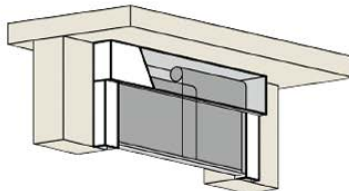

Exposed Mount (HBEM_01)

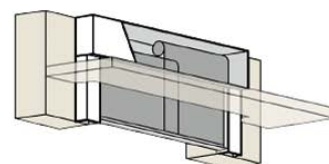

Shadow Gap (HB5G_01)

SIDE GUIDE MOUNTING OPTIONS

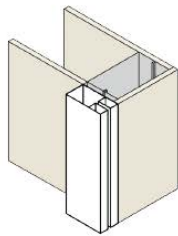

Exposed Flush (SGMEF_01)

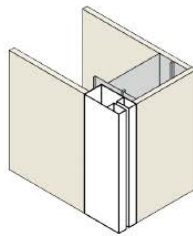

Butt to Wall Flush (SGMBWF_02)

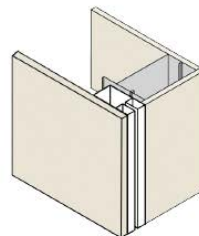

Inset in Drywall (SGMIDF_03)

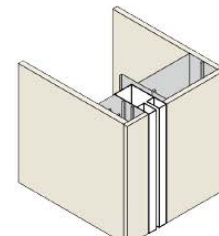

Inset in Wall Flush (SGMIWF_3A)

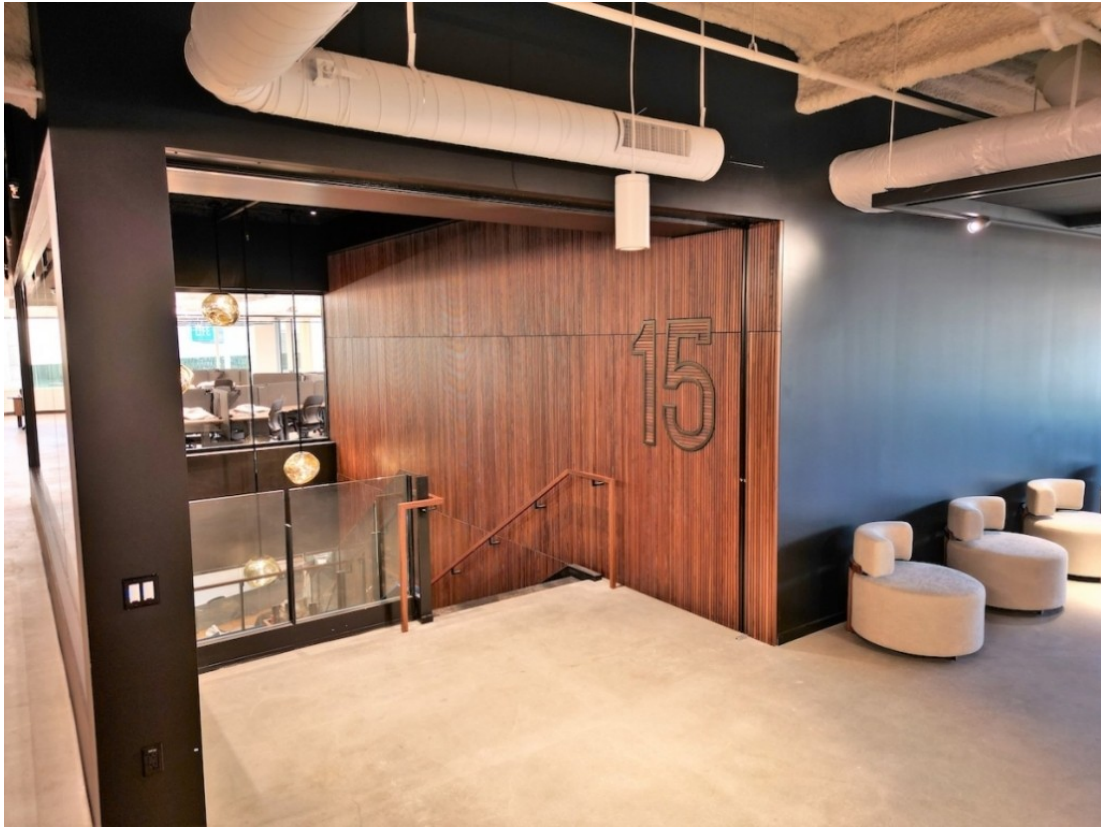

DSI-HS10B in closed position



DSI-HS10B in the deployed position

- Cost-effective
- Lightweight – 75% lighter than overhead steel fire doors
- Compact headbox – as little as 9” but no more than 12” of headroom required for larger sizes
- Minimal side room required — 4” for any size
- No size restrictions – Almost unlimited in size
- Various egress options are available
- A 24-volt system with Battery backup is standard
- Gravity Failsafe System with Auto reset
- No exposed mechanisms, gears, chains, or motor parts
- It can be almost completely hidden in your architectural design scheme
- Code Compliant – Tested and Labeled to UL 10B 180 minutes with hose stream. UL1784 “S” label

Contact Door Systems today to discover innovative solutions to your existing smoke and fire protection needs and assist in the concept, design, and layout of all future smoke and fire containment projects.



AIA Courses for Your Team!

AIA Courses are now available for the DSI-HS10B Fire Curtain.

[Schedule Yours Today!](#)

You can also find us on the following:



[Click here](#) to access Door Systems’s design files including BIM/Revits models, CAD drawings, specifications, videos and related documents.



For more information feel free to visit our website at www.doorsysinc.com or call us at 866-534-3667

We are also available for architectural presentations, lunch and learns or come visit our showrooms.

[Download Our New Brochure!](#)

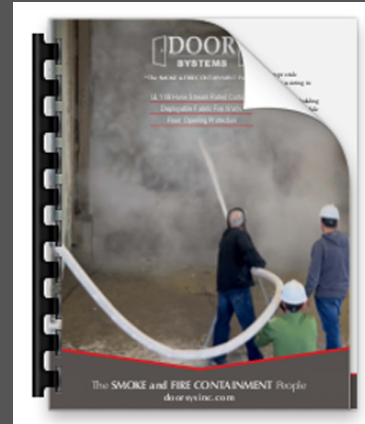

For more information feel free to visit our website at www.doorsysinc.com or call us at 866-534-3667

We are also available for architectural presentations, lunch and learns or come visit our showrooms.

[Download Our New Brochure!](#)

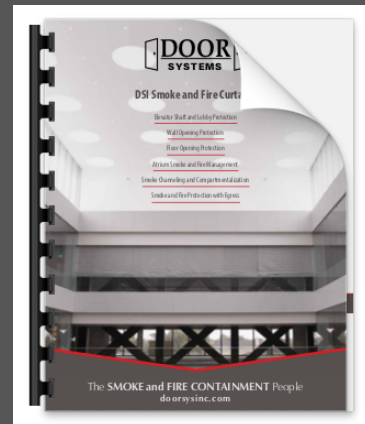

Our mailing address is:
Door Systems
1150 S Las Brisas
Placentia, CA 92870

[Download Our New Brochure!](#)

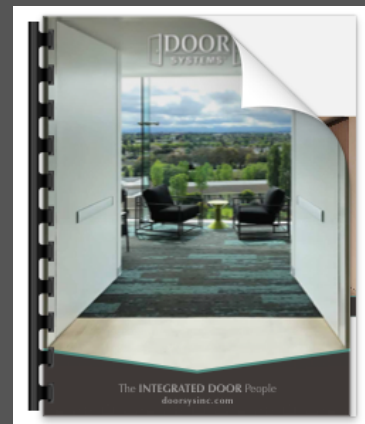

Northern California Office

So California Office and other Territories

Salvador Perez
Architectural Sales
587 Division Street
Campbell, Ca 95008
(408) 477-4300
Cell: (714) 586-7281

Email salvador@doorsysinc.com

Salvador Perez
Architectural Sales
1150 S Las Brisas
Placentia, CA 92870
(866) 534-DOOR (3667)
Cell: (714) 586-7281

Email salvador@doorsysinc.com

Sent by



© 2024 Door Systems