



DATA CUT SHEET



MODEL DSI-HS10B

Hose Stream Rated Smoke and Fire Curtain

The DSI-HS10B Hose Stream Rated Smoke and Fire Curtain incorporates the cutting-edge technology of our UL 10D curtain products but with the advantage of being code compliant in any fire wall rated up to 3 hours.

With a UL10B 3-hour fire rating, the DSI-HS10B Fire Curtain can be used in fire walls and fire barrier walls as a replacement solution to traditional Coiling Steel Fire doors.

The assembly is comprised of a proprietary multi layered fire rated fiberglass/stainless steel fabric wound around a roller which is encased in a compact head box that is typically installed above the ceiling with side guides that are buried in the wall. This makes the system virtually invisible until activated.

Compliant with...

Code	Description
UL 10B	With Hose Stream – 180 minutes
UL 1784	Air leakage test of door assemblies
UL 864	Control Units for Fire Protective Signaling Systems



GUARANTEED QUALITY

Door Systems guarantee high quality products, tested to both UL and BS standards.

ADVANTAGES vs STEEL FIRE DOORS

- Cost effective
- Lightweight – 75% lighter than overhead steel fire doors
- Compact headbox – as little as 9" but no more than 12" of headroom required for larger sizes.
- Minimal Side room required -- 4" for any size
- No size restrictions – Almost unlimited in size
- Various egress options available
- 24-volt system with Battery backup standard
- Gravity Failsafe System with Auto reset
- No exposed mechanisms, gears, chains, or motor parts
- Can be almost completely hidden in your architectural design scheme.
- Code Compliant - Tested and Labeled to UL 10B 180 minutes with hose stream. UL1784 "S" label



The SMOKE & FIRE CONTAINMENT People

MODEL DSI-HS10B

Hose Stream Rated Smoke and Fire Curtain

HEADBOX FINISHING OPTIONS

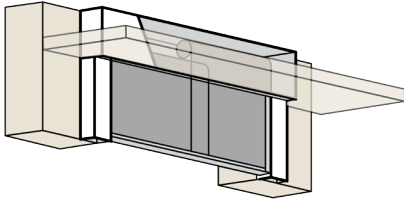

Flush to Ceiling (HBFC_01)

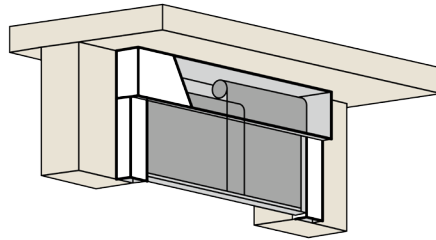

Exposed Mount (HBEM_01)

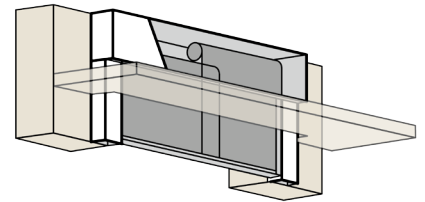

Shadow Gap (HBSG_01)

SIDE GUIDE MOUNTING OPTIONS

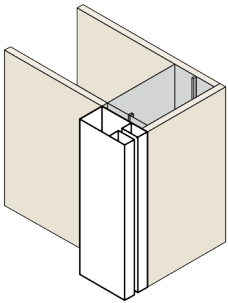

Exposed Flush (SGMEF_01)

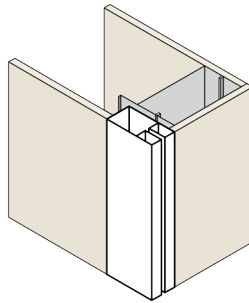

Butt to Wall Flush (SGMBWF_02)

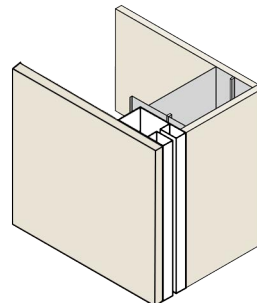

Inset in Drywall (SGMIDF_03)

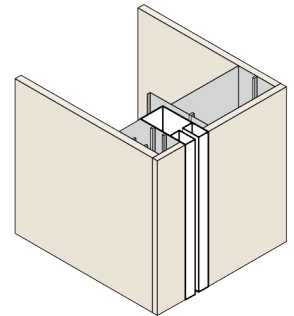

Inset in Wall Flush (SGMIWF_3A)

SINGLE ROLLER MOUNTING OPTIONS

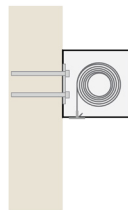

Fixed Mount (SRMFM_01)

Fixed directly to the lintel above an opening.

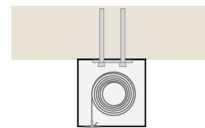

Soffit Fixed Mount (SRMSFM_01)

Fixed directly to the underside of the soffit slab.

MULTIPLE ROLLER MOUNTING OPTIONS

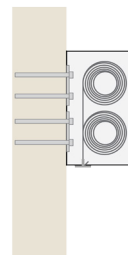

Over/Under Arrangement (MRMOU_01)

Fixed directly to the lintel above an opening.

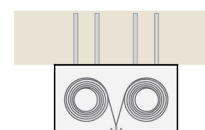

Side by Side Arrangement (MRMSS_01)

Fixed directly to the underside of the soffit slab.

DSI-HS10B Fabric Fire Curtain

Rolling Steel Fire Doors

Comparison Chart

DSI-HS10B FABRIC FIRE CURTAIN vs. ROLLING STEEL FIRE DOORS



Features & Qualifications	DSI-HS10B HOSE STREAM RATED SMOKE AND FIRE CURTAIN	Overhead Coiling Steel Fire Doors
Fire Label	UL 10B with Hose Stream	UL 10B with Hose Stream
Fire Rating	20, 90, or 180 minutes	20, 90, or 180 minutes
Smoke Label	UL 1784 (Standard)	UL 1784 (Optional)*
Smoke Seals	Not Required	Required for "S" Label
Fail Safe Operation	Standard	Optional for an added cost
Minimum Head Room Requirement	9"	16"
Maximum Head Room Requirement	12"	30"
Side Clearance Required	4" on all sizes	Varies from 7 1/2" - 13 1/2"
Weight	3-5 lbs. per Sq. Ft.	13-15 lbs. per Sq. Ft.
Maximum Opening Size	984' Wide x 26' Tall*	24' Wide x 24' Tall*
Activation Function	Fire Alarm &(or) Fusible Link	Fire Alarm &(or) Fusible Link
Auto Reset Function	Standard	Optional for an added cost
Egress	Multiple options available	Not available
Battery Back-up	Standard	Optional for an added cost
Power Requirements	24V standard	120V Minimum
Finishes	Factory Primed finish	Factory Primed finish

* Contact Factory for options or other sizes



(866) 534-DOOR (3667) | doorsysinc.com | contact@doorsysinc.com